

10900

12550

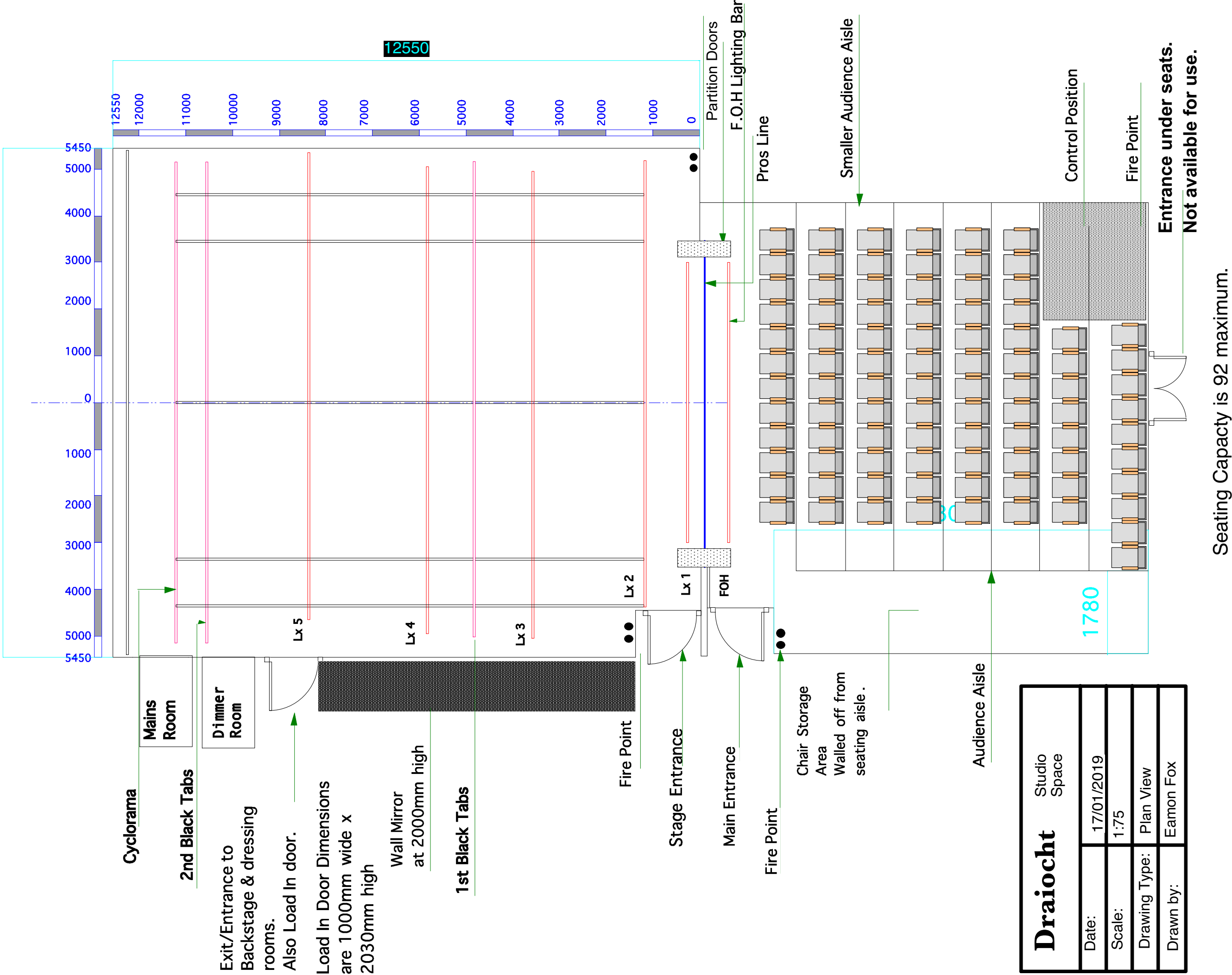

Seating Capacity is 92 maximum.

Draiocht Studio Space	
Date:	17/01/2019
Scale:	1:75
Drawing Type:	Plan View
Drawn by:	Eamon Fox

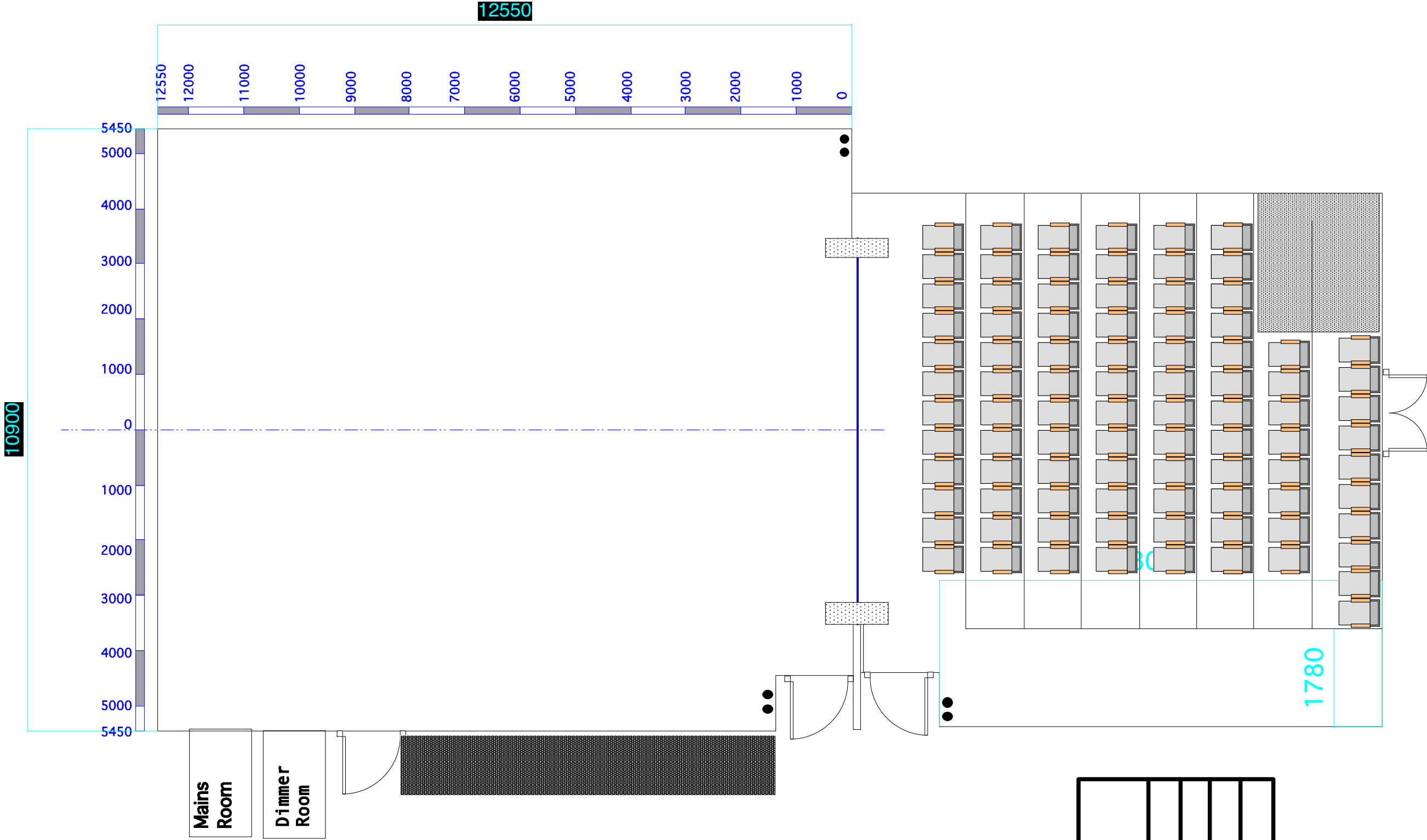

Draiocht Studio Space	
Date:	17/01/2019
Scale:	1:75
Drawing Type:	Plan View
Drawn by:	Eamon Fox

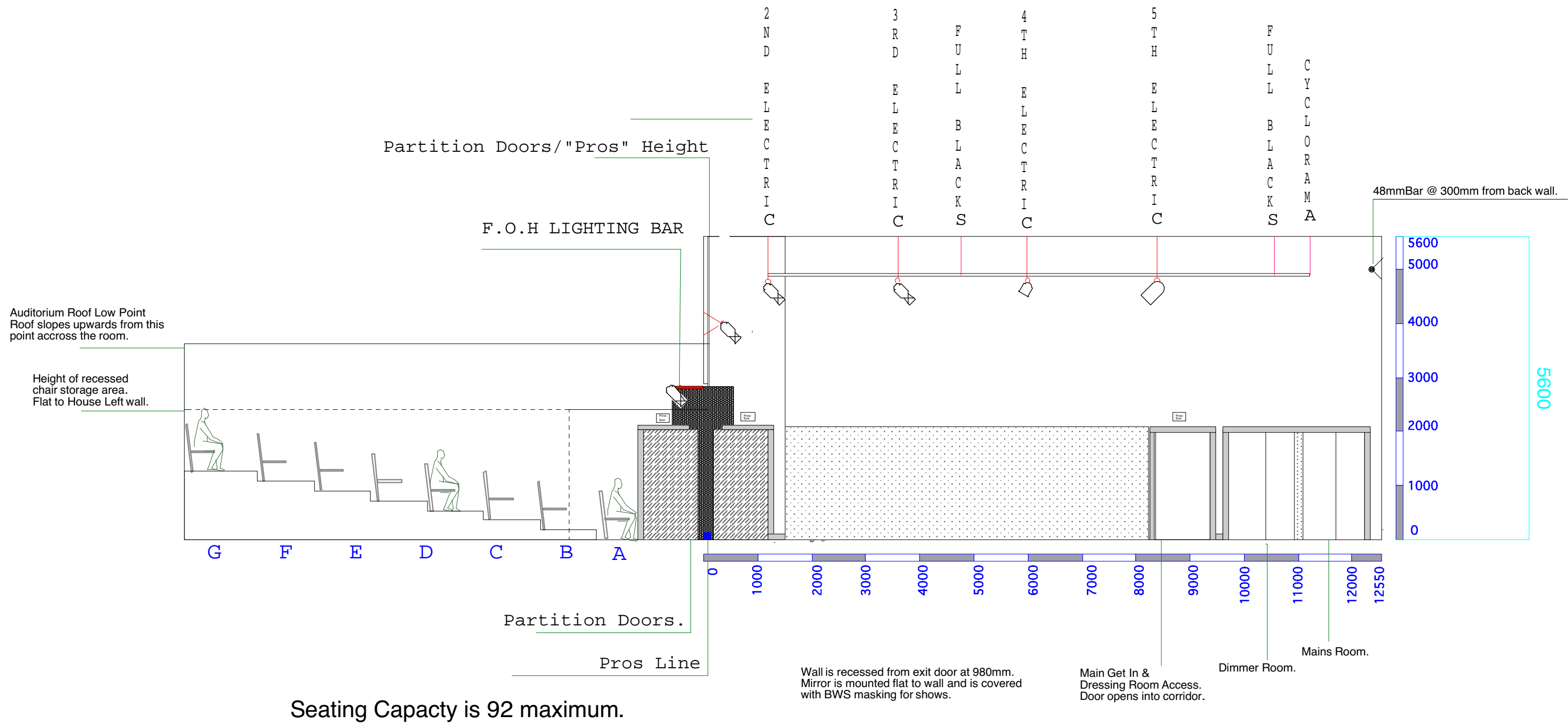

Draiocht Studio Space	
Date:	17/01/2019
Scale:	1:75
Drawing Type:	Section View Right
Drawn by:	Eamon Fox

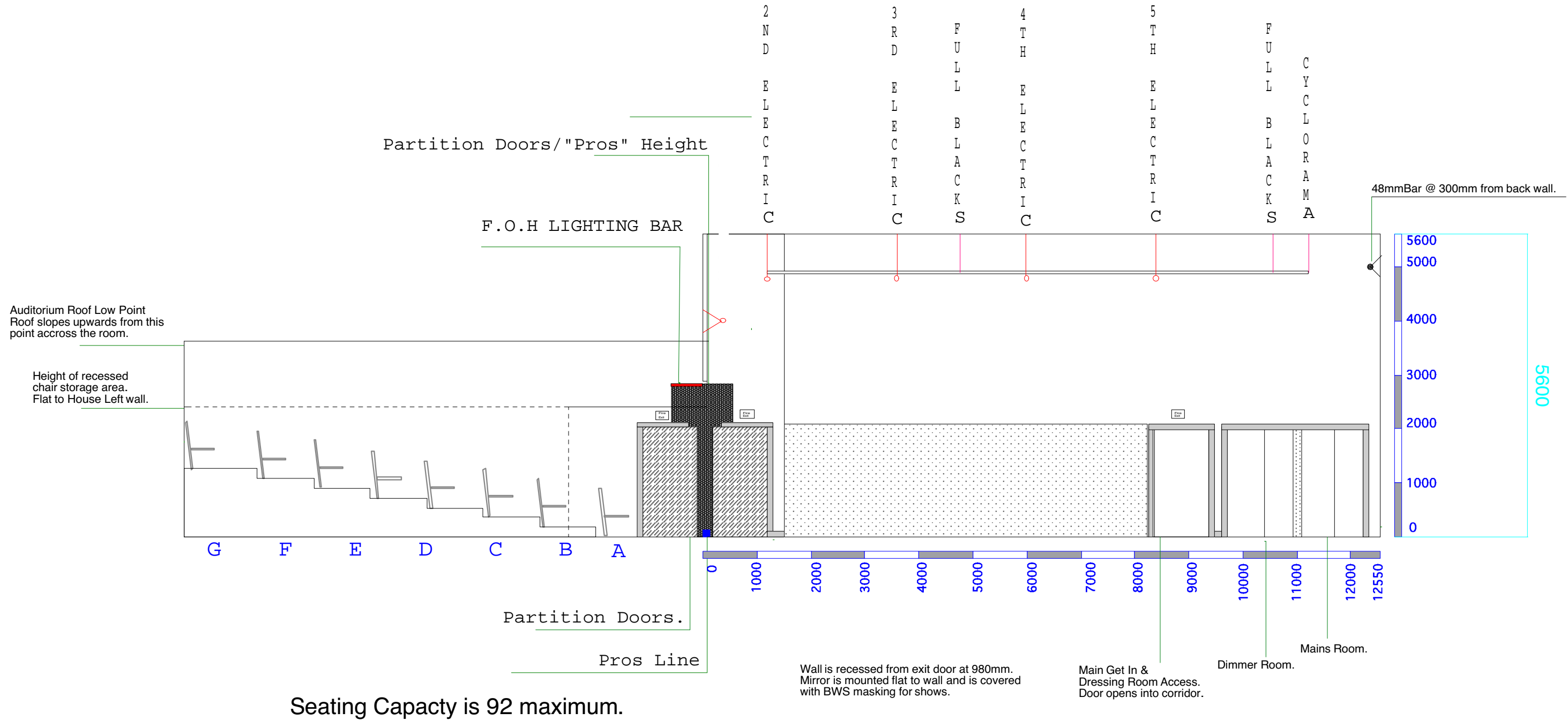

Draiocht Studio Space	
Date:	17/01/2019
Scale:	1:75
Drawing Type:	Section View Right
Drawn by:	Eamon Fox

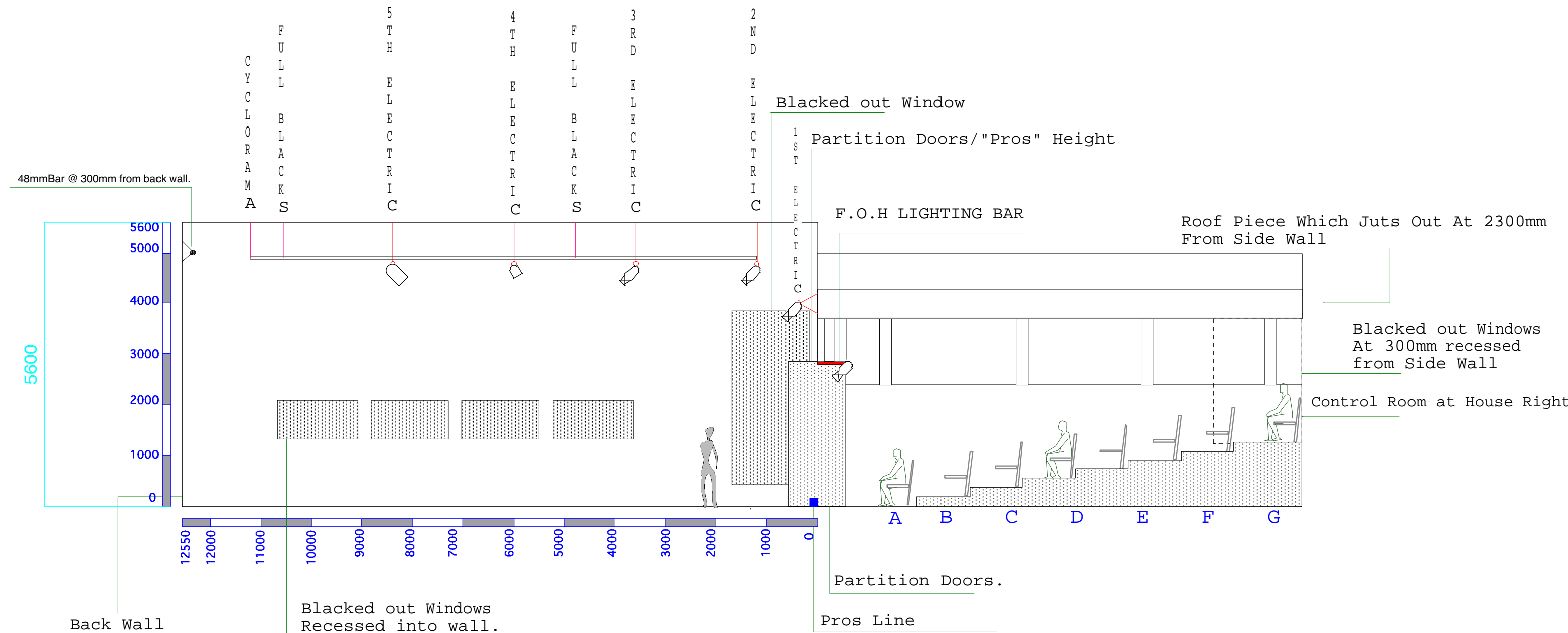

Draiocht Studio Space	
Date:	17/01/2019
Scale:	1:75
Drawing Type:	Section View Left
Drawn by:	Eamon Fox

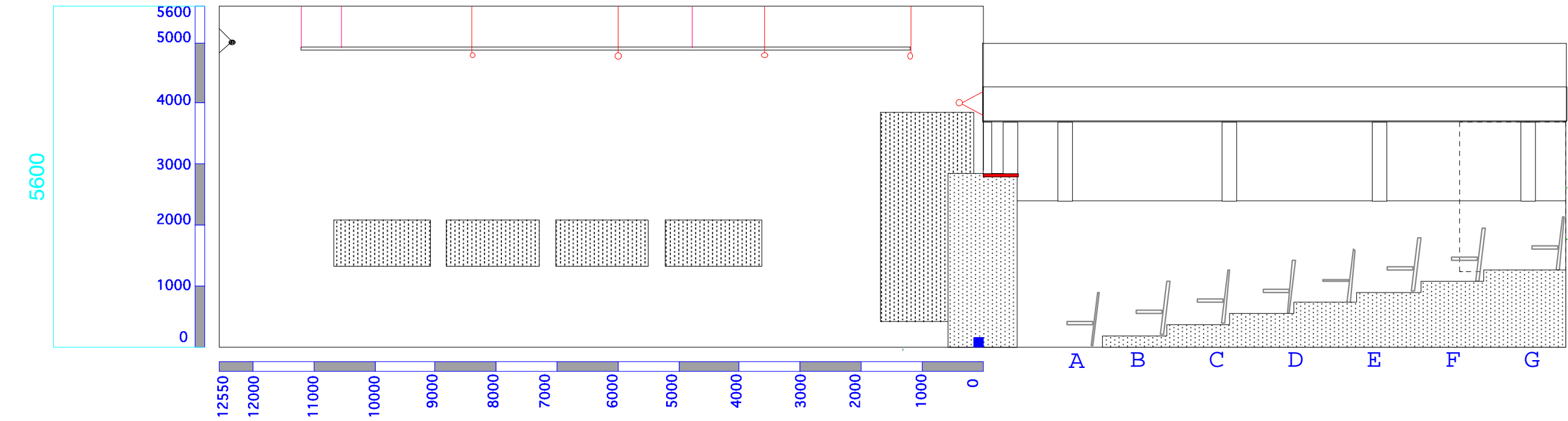

<div><div>Draiocht</div><div>Studio Space</div></div>	
Date:	17/01/2019
Scale:	1:75
Drawing Type:	Section View Left
Drawn by:	Eamon Fox

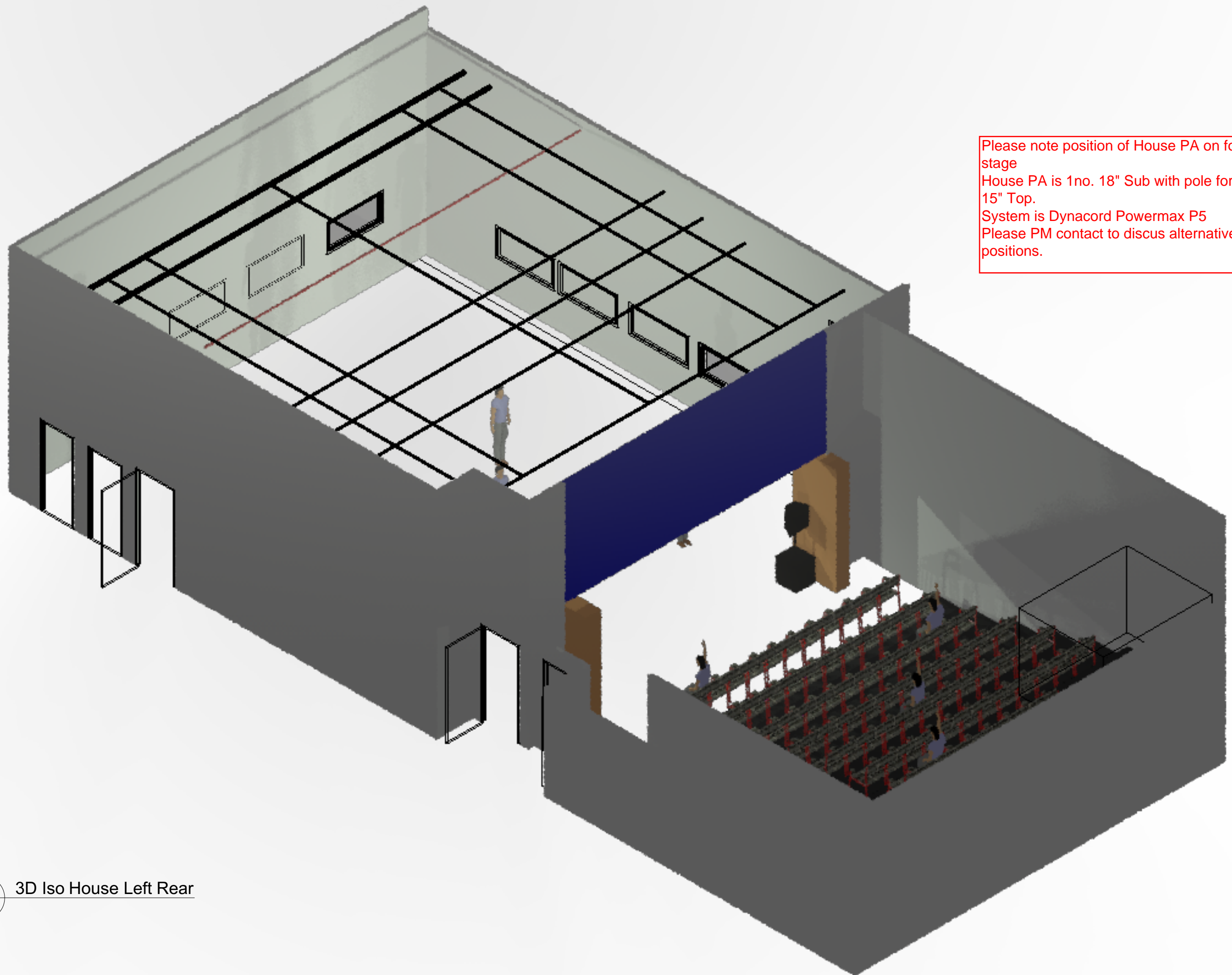

Please note position of House PA on fore stage
House PA is 1no. 18" Sub with pole for 15" Top.
System is Dynacord Powermax P5
Please PM contact to discuss alternative positions.

Please note position of House PA on fore stage
House PA is 1no. 18" Sub with pole for 15" Top.
System is Dynacord Powermax P5
Please PM contact to discuss alternative positions.

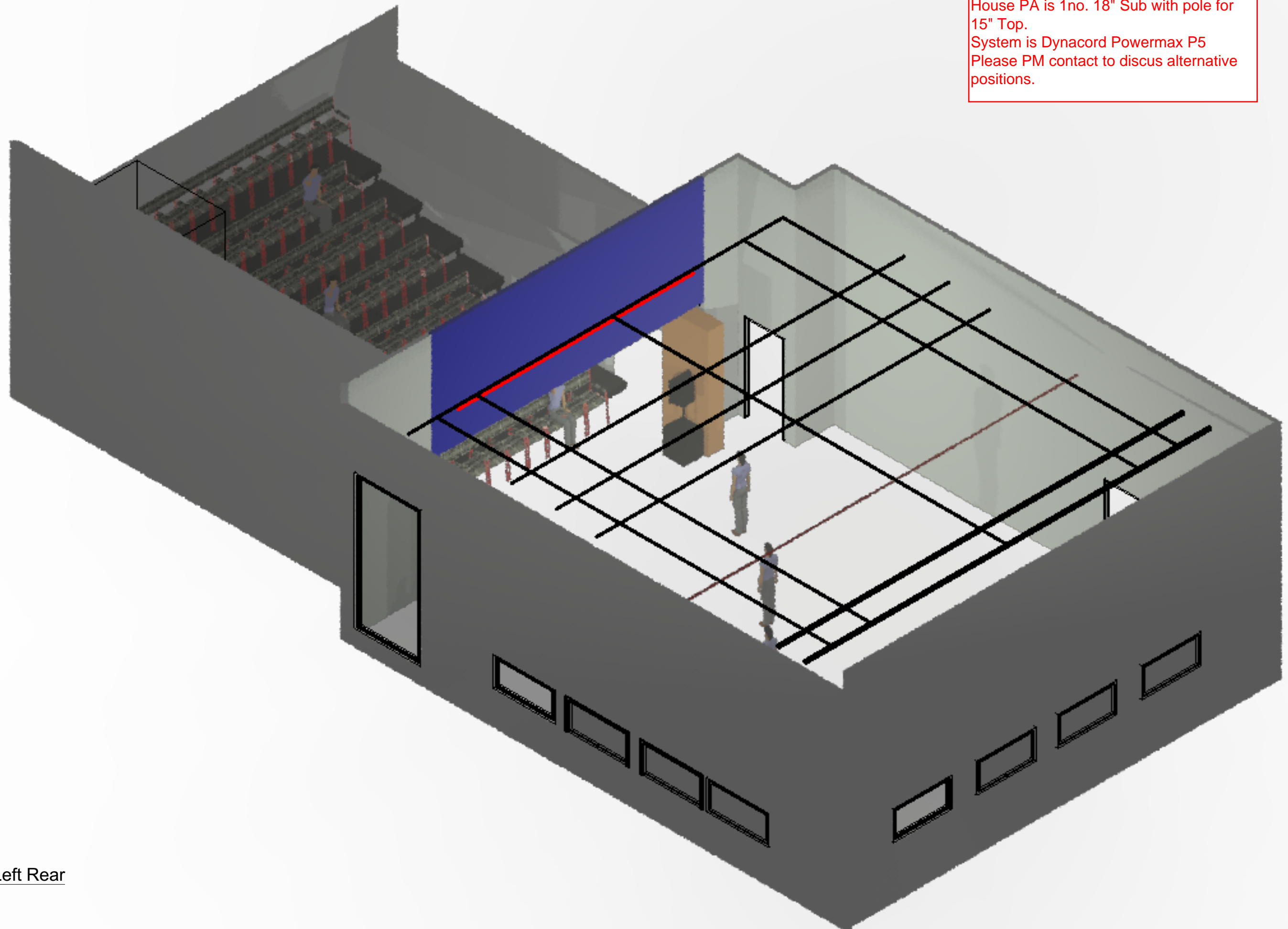

Please note position of House PA on fore stage
House PA is 1no. 18" Sub with pole for 15" Top.
System is Dynacord Powermax P5
Please PM contact to discuss alternative positions.

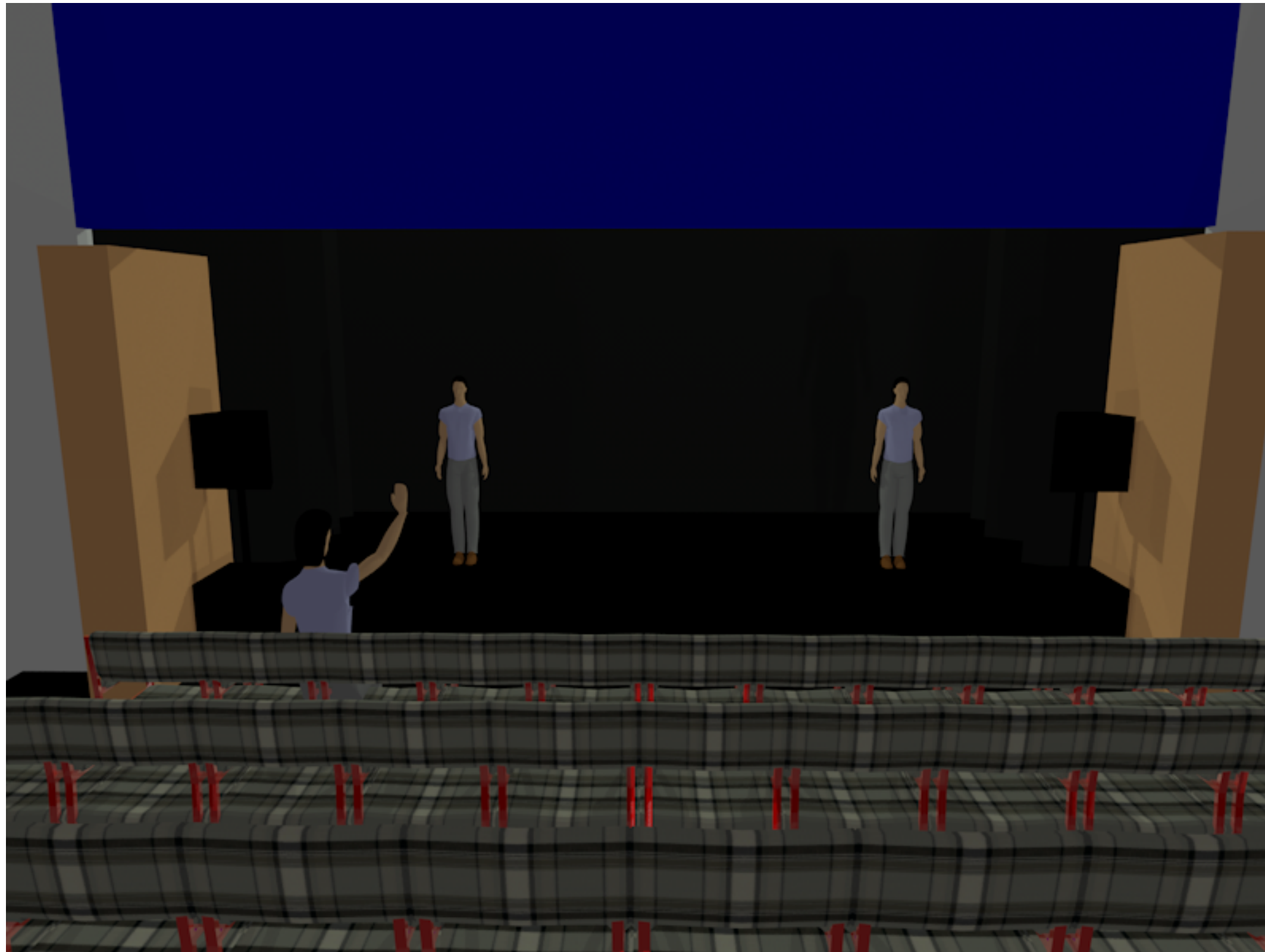

Please note position of House PA on fore stage
House PA is 1no. 18" Sub with pole for 15" Top.
System is Dynacord Powermax P5
Please PM contact to discuss alternative positions.

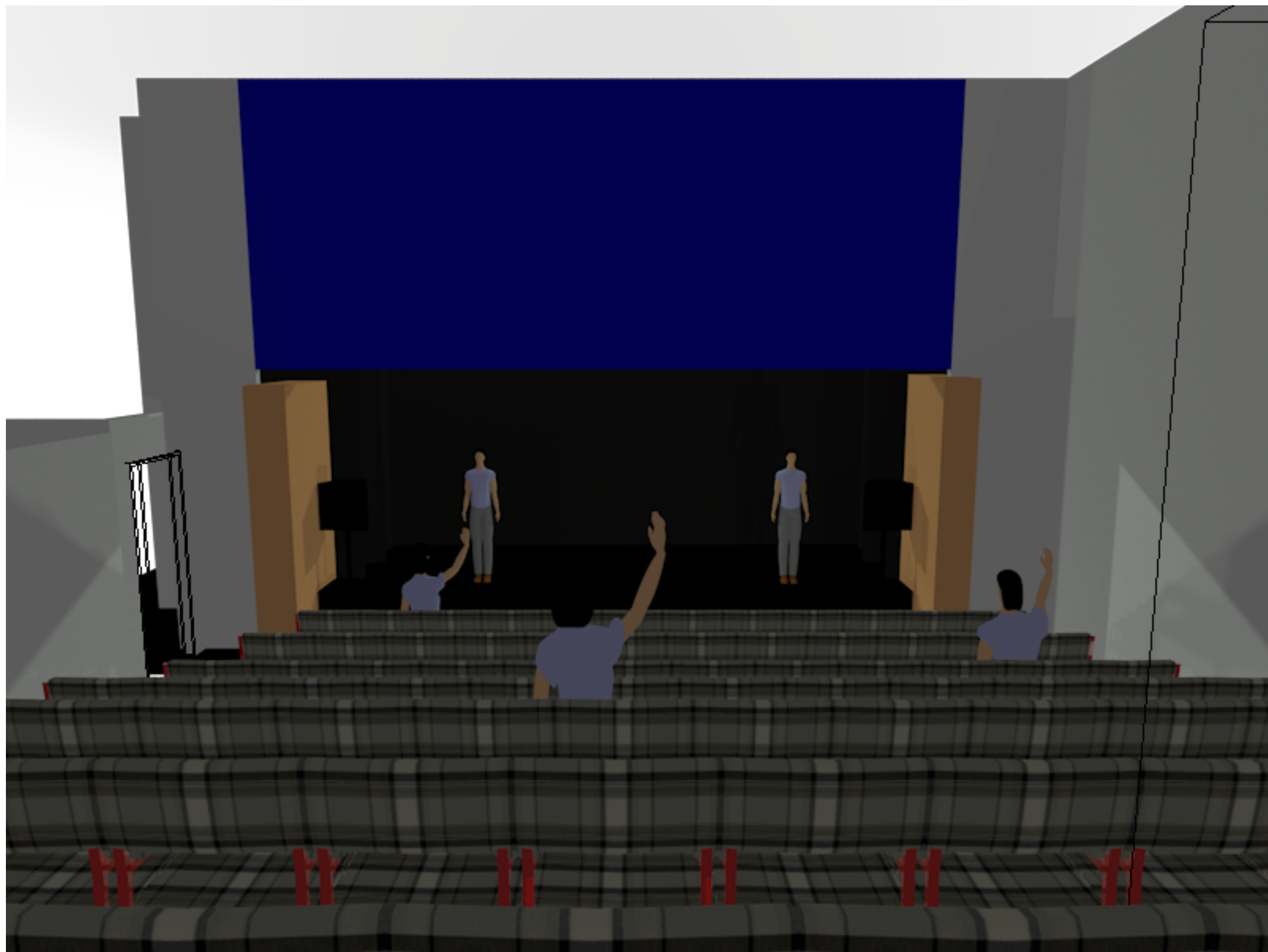

- 1) Stage floor is level w/auditorium and the seating is raked.
- 2) Studio is located on 1st floor not ground floor
Get In access is through the USR Stage door
See plan for dimensions.
- 3) Lighting bars are IWB's at
100mm lower than grid
- 4) Bar height is at 4900mm
Electrics 2-5 bars at 4800mm from Floor.
Electrics 1 at 4000mm from Floor.
- 5) All hanging piping is checked annually and SWL & UDL's are available.
- 6) The US Black Tabs are on a Traveller track. They are not on a bar.
- 7) The MS Black Tab is not moveable.
- 8) The parition doors close to create two different spaces. They are dressed in black wool serge for shows.
- 9) It is not permissable to fix into the floor.
- 10) Stage floor is wooden floor suitable for dance with black dance floor permantly in situ.

Playing depth from Seating edge to farthest US Black point is 7640mm
 Width from leg to leg is 8780mm
 Legs ran US/DS German style on indicated bars.

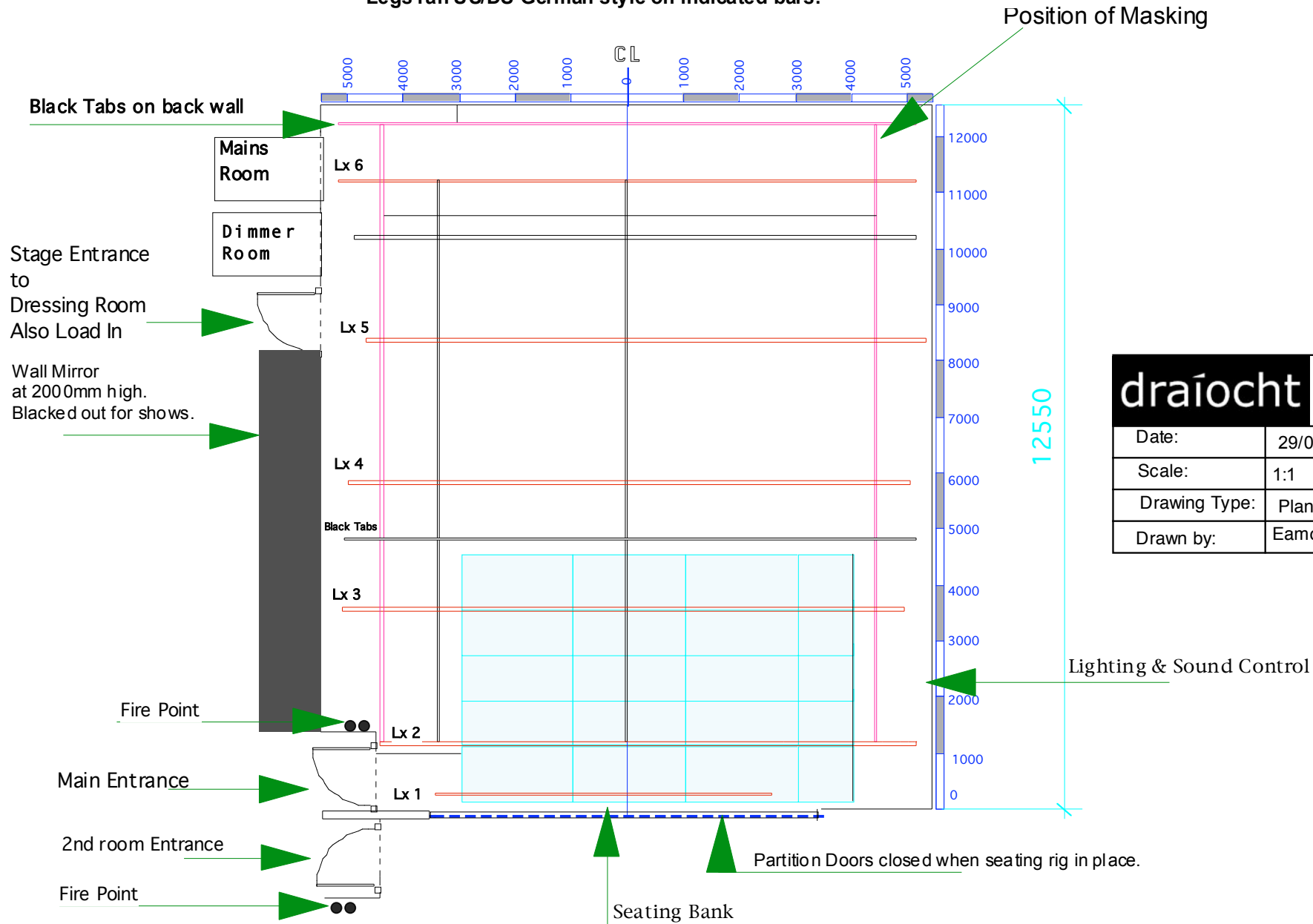

draíocht Studio Space One Room	
Date:	29/06/2010
Scale:	1:1
Drawing Type:	Plan View
Drawn by:	Eamon Fox

The 2nd Room/normal auditorium can be used for overflow and storage of ladders et al etc.

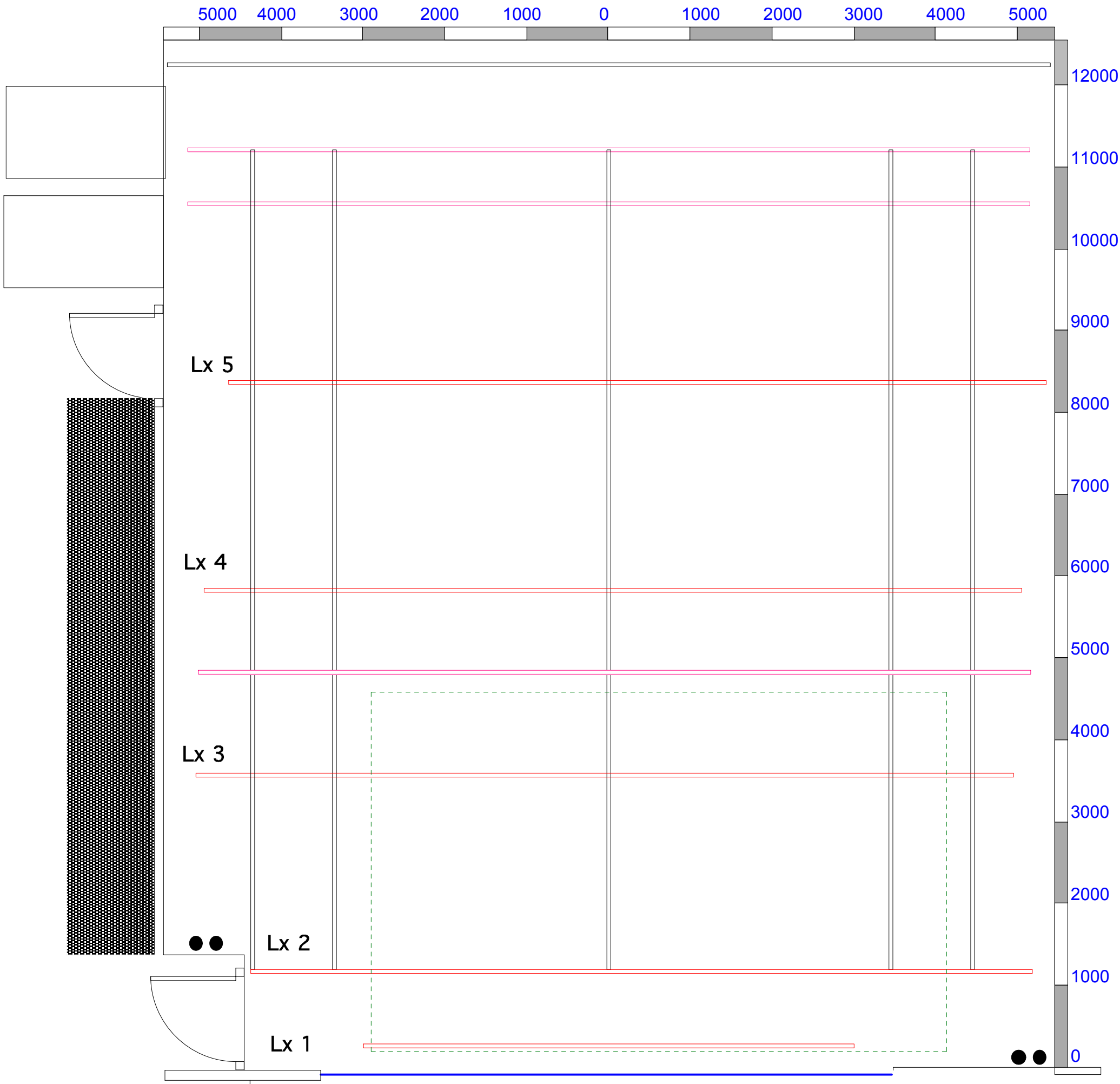

Draiocht			
Centre For The Arts			
Spreacha Top Plan			
2D Overhead View			
Production Manager: Eamon Fox			
e: eamon@draiocht.ie		tel: +353 (1) 809 8023	
w: www.draiocht.ie			
SCALE: 1:50	DATE: 11/11/14	DRWN: Eamon Fox	REV: 2014

Note:

The Spreacha format is achieved with the installation of rostra to create a seating layout. Unless specifically agreed, this method of staging is intended for children's theatre only and you may ignore this layout for a standard show etc.
This layout utilises the full ability of the larger part of the studio space.
The standard seats are not used in this format.
The maximum capacity is limited to 72.

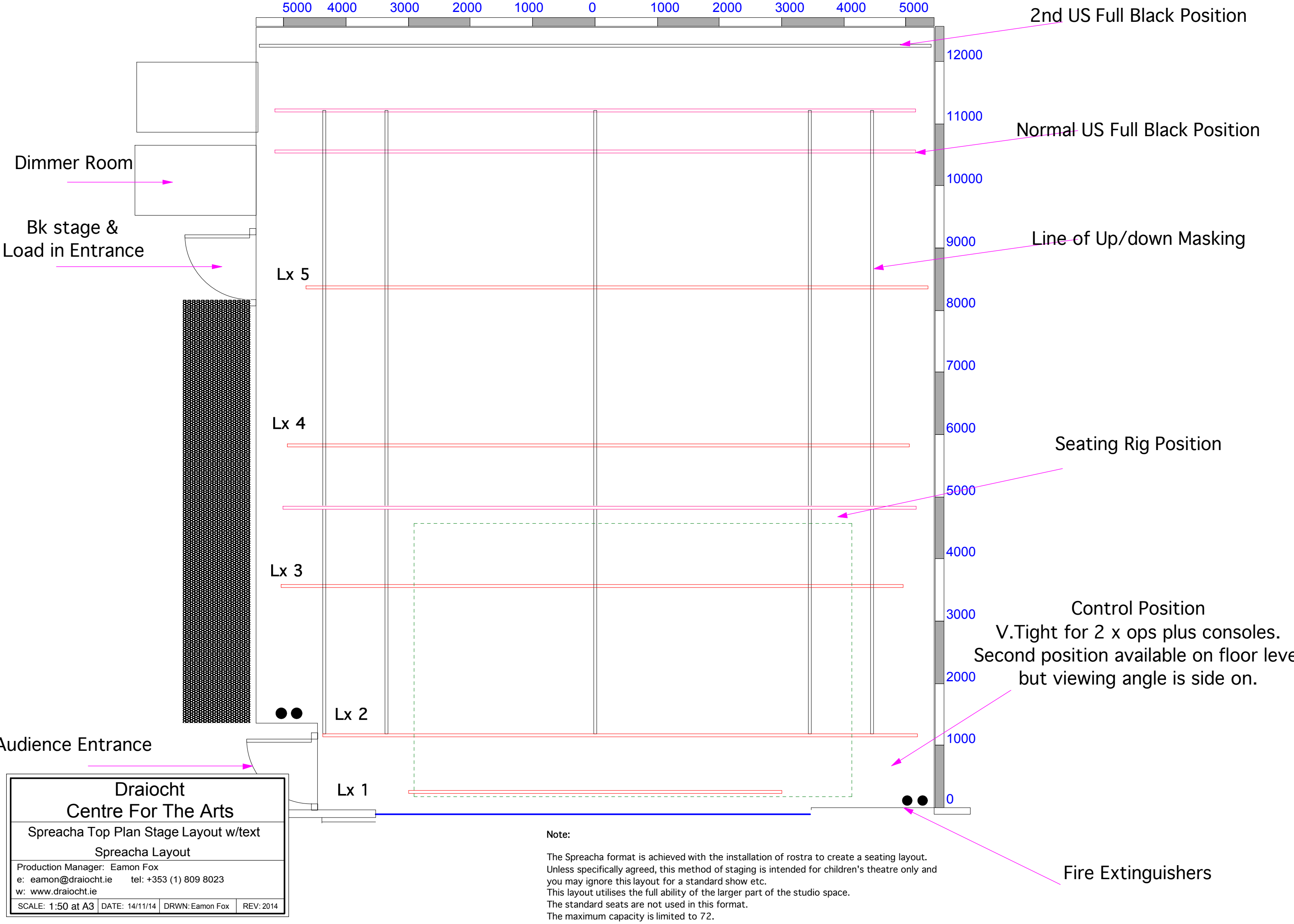

Draiocht
Centre For The Arts

Spreacha Top Plan View w/seating
Spreacha Layout

Production Manager: Eamon Fox
e: eamon@draiocht.ie tel: +353 (1) 809 8023
w: www.draiocht.ie

SCALE: 1:50 at A3 DATE: 14/11/14 DRWN: Eamon Fox REV: 2014

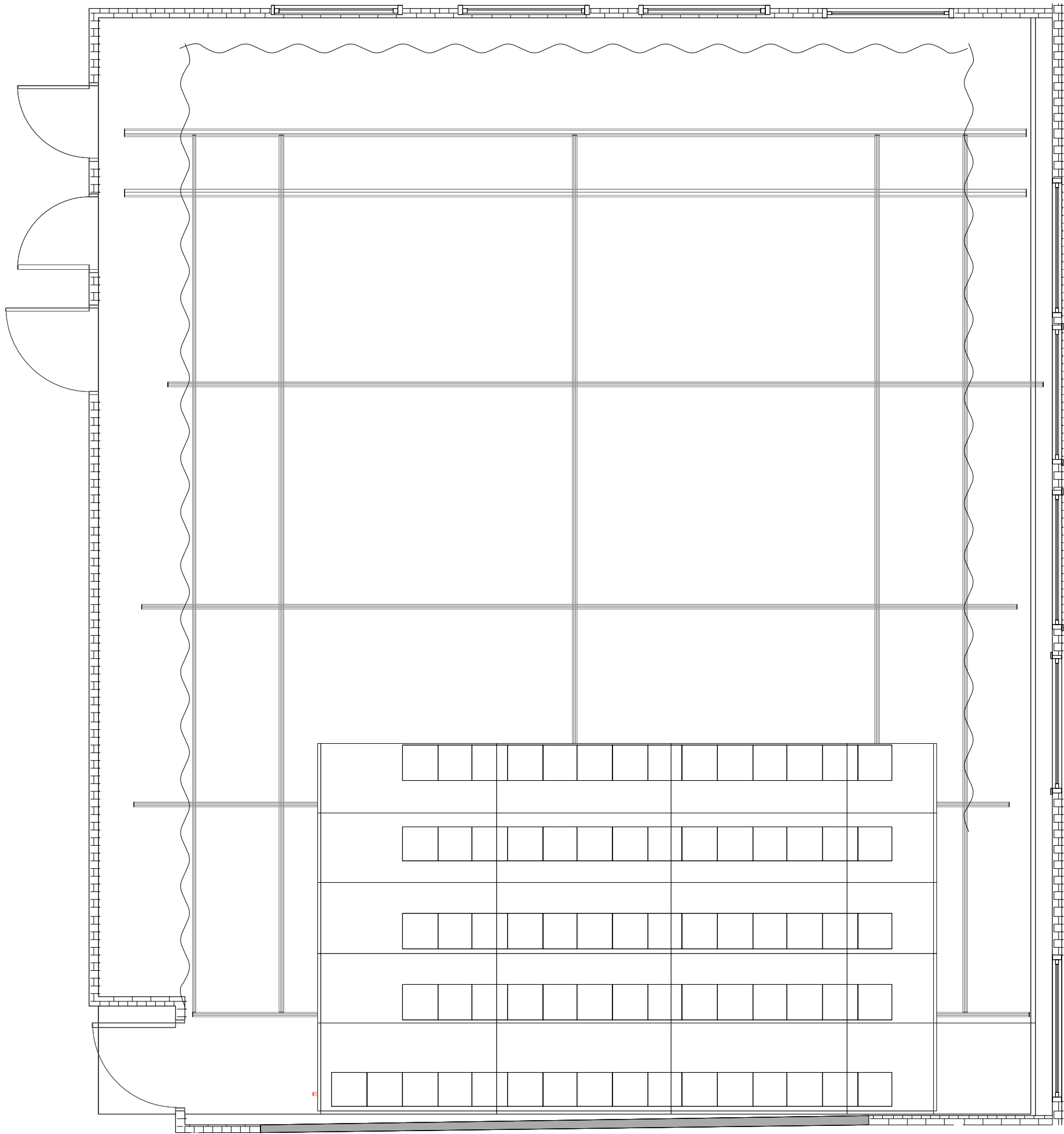

Note:

The Spreacha format is achieved with the installation of rostra to create a seating layout. Unless specifically agreed, this method of staging is intended for children's theatre only and you may ignore this layout for a standard show etc. This layout utilises the full ability of the larger part of the studio space. The standard seats are not used in this format. The maximum capacity is limited to 72.

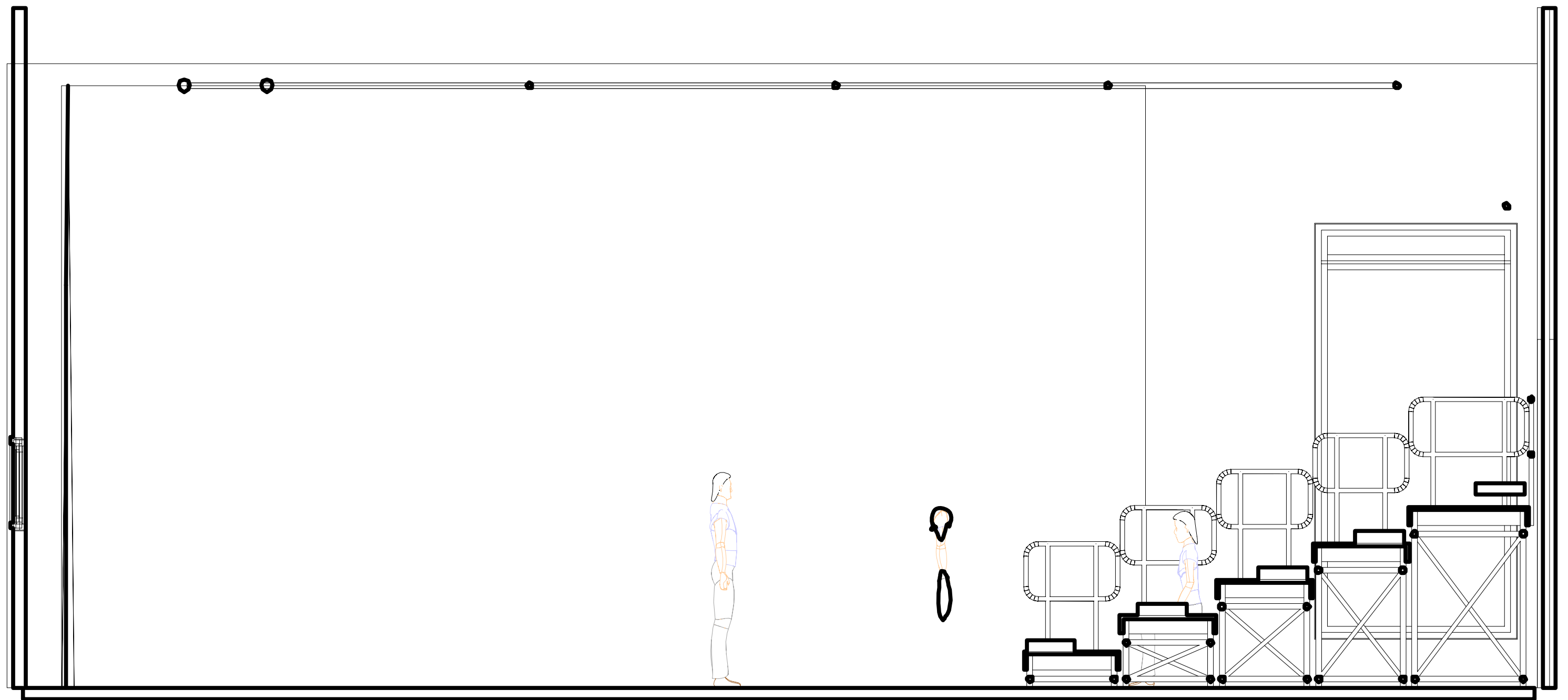

1 [Drawing Title]
Scale: 1:33

<h1>Draiocht</h1> <h2>Centre For The Arts</h2>			
<h3>Spreacha Section Left View</h3> <h3>Spreacha Layout</h3>			
Production Manager: Eamon Fox e: eamon@draiocht.ie tel: +353 (1) 809 8023 w: www.draiocht.ie			
SCALE: No Scale	DATE: 15/06/15	DRWN: Eamon Fox	REV: 2015

Note:

The Spreacha format is achieved with the installation of rostra to create a seating layout. Unless specifically agreed, this method of staging is intended for children's theatre only and you may ignore this layout for a standard show etc. This layout utilises the full ability of the larger part of the studio space. The standard seats are not used in this format. The maximum capacity is limited to 72.

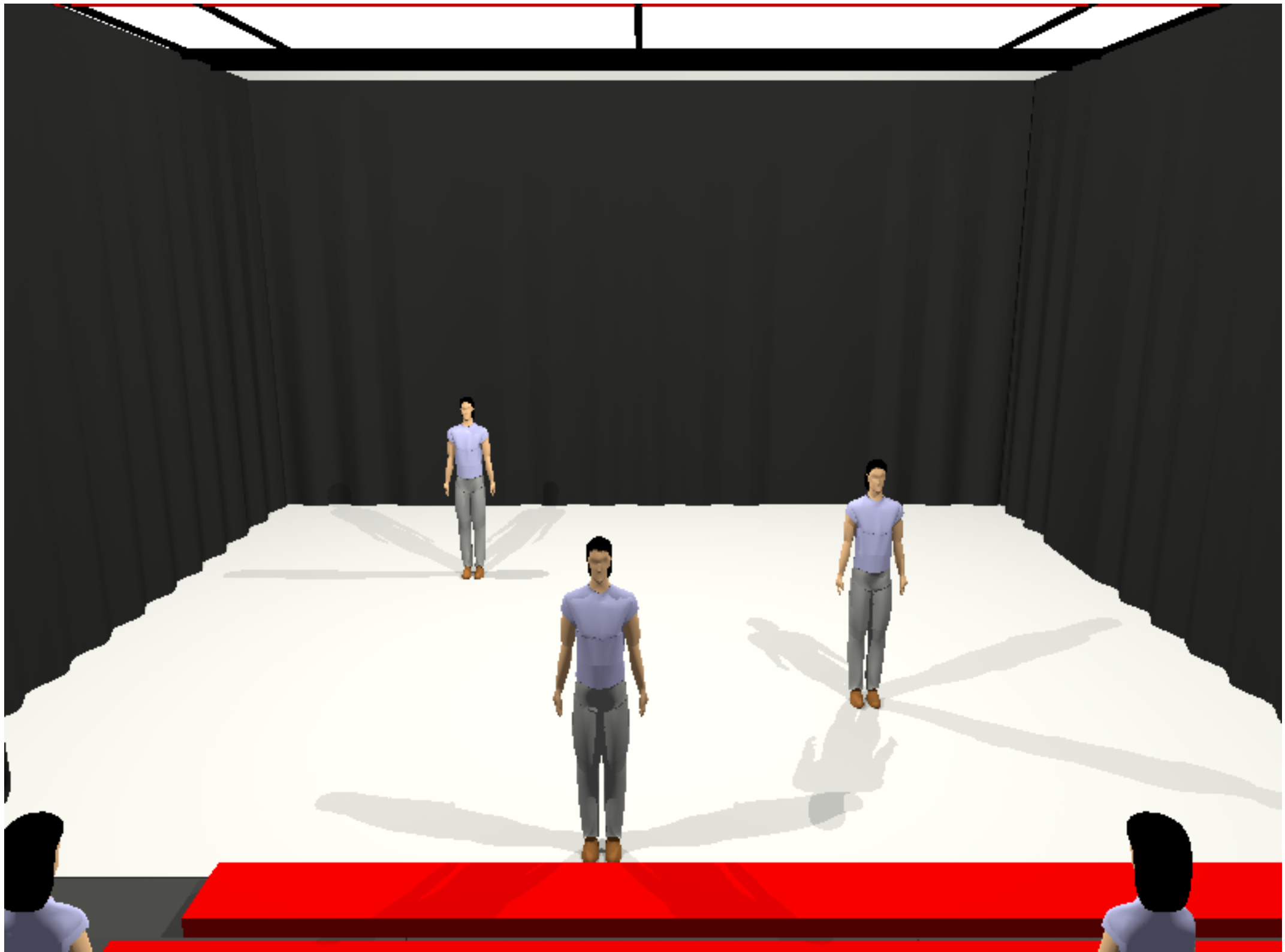

Draiocht Centre For The Arts Spreacha 3D Layout Front Elevation			
Production Manager: Eamon Fox e: eamon@draiocht.ie tel: +353 (1) 809 8023 w: www.draiocht.ie			
SCALE: No Scale	DATE: 15/06/15	DRWN: Eamon Fox	REV: 2015

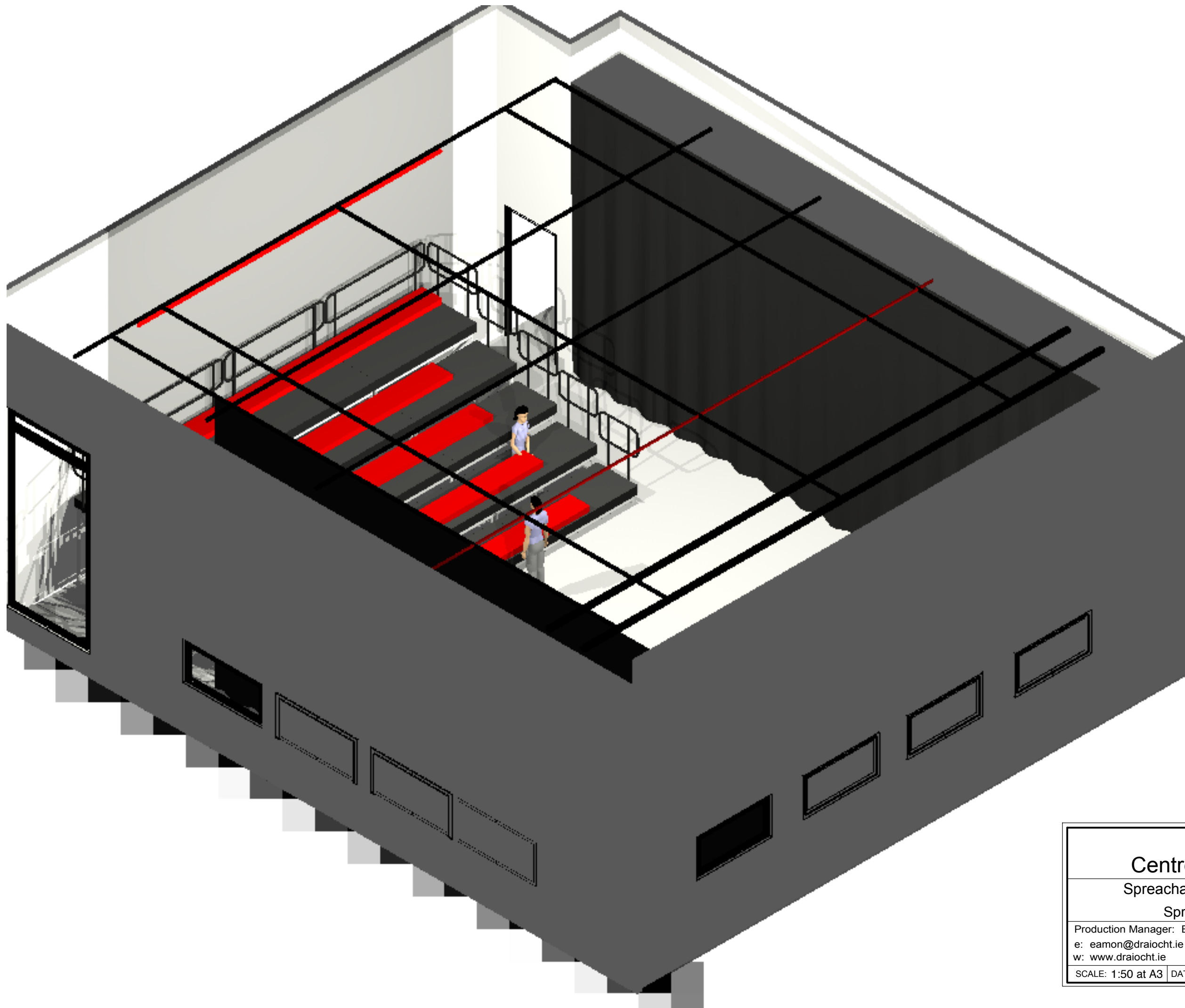

Draiocht
Centre For The Arts

Spreacha 3D ISO Right Rear

Spreacha Layout

Production Manager: Eamon Fox

e: eamon@draiocht.ie tel: +353 (1) 809 8023

w: www.draiocht.ie

SCALE: 1:50 at A3 DATE: 15/06/15 DRWN: Eamon Fox REV: 2015



Draiocht			
Centre For The Arts			
Spreacha 3D Top Plan			
3D Overhead View			
Production Manager: Eamon Fox			
e: eamon@draiocht.ie		tel: +353 (1) 809 8023	
w: www.draiocht.ie			
SCALE: No Scale	DATE: 15/06/15	DRWN: Eamon Fox	REV: 2015

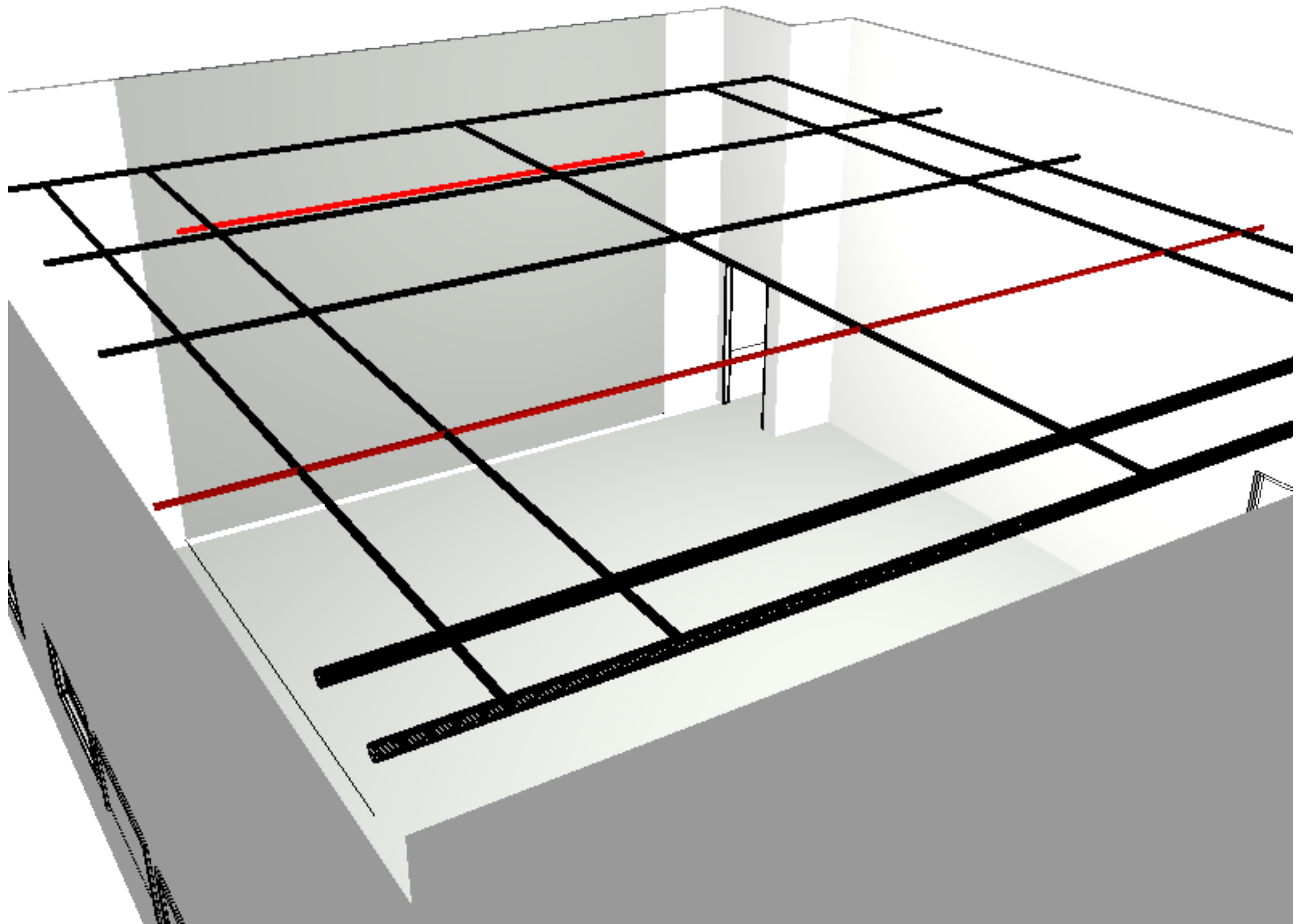

N.B:Do not scale off image.
Please contact Production Manager to discuss.

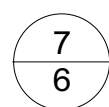
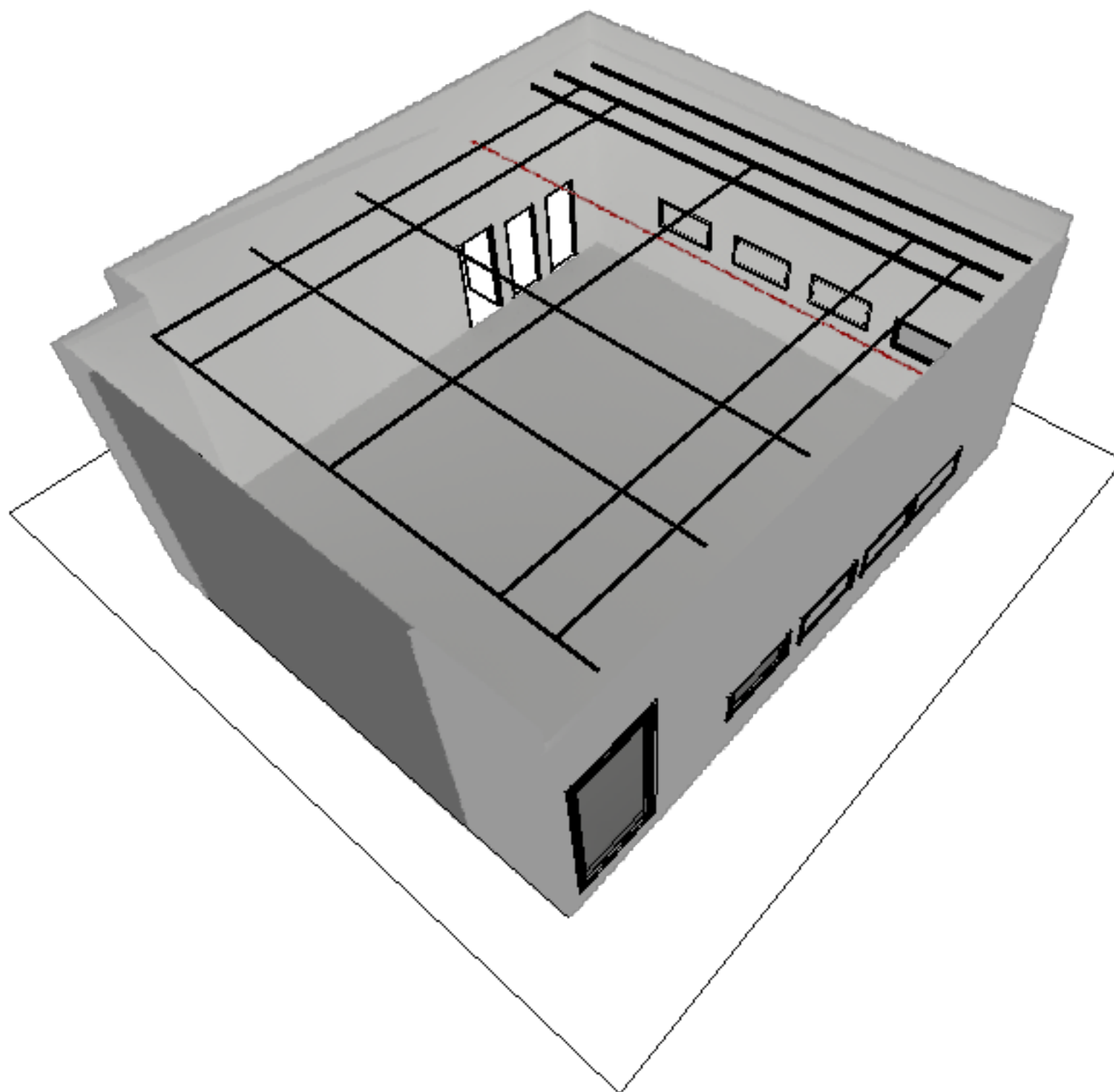

3D Front Sprecha ISO No Seating

N.B:Do not scale off image.
Please contact Production Manager to discuss.

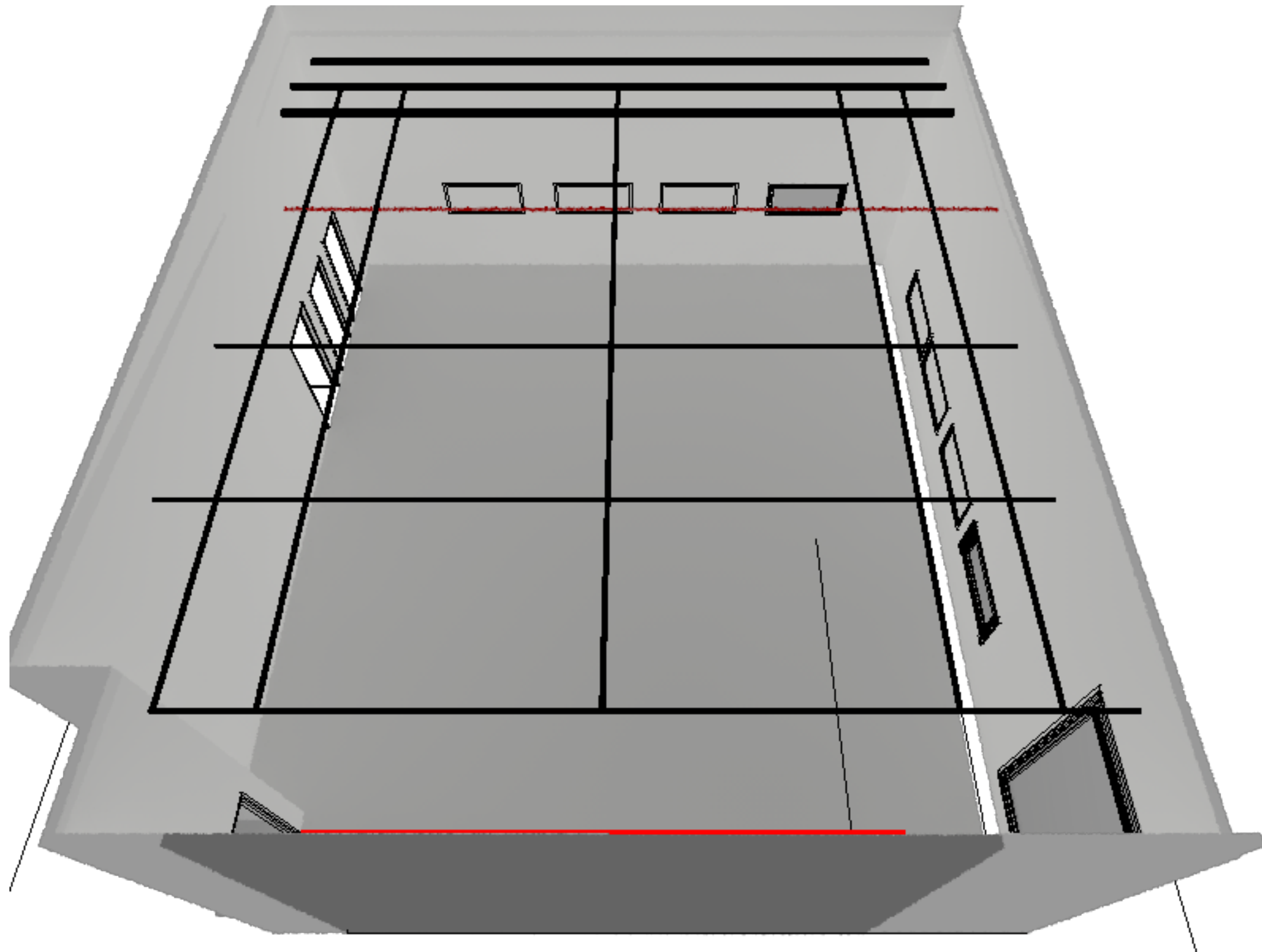

N.B: Do not scale off image.
Please contact Production Manager to discuss.

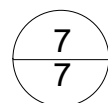

Top View Spreacha No seating